

PHYSICAL AND SOCIO-ECONOMIC PROFILE

II. PHYSICAL PROFILE

Geographic Location

Barangay Betag is located on the southern part of La Trinidad Valley. The area is basically of flat terrain. This barangay is bounded on the north by barangay Poblacion, on the south by barangay Pico, on the east by barangay Balili, and on the west by barangay Poblacion, Wangal and Puguis.

Barangay Betag covers Km.5 to Km.6 starting from the La Trinidad Trading Post up to the bridge down Capitol.

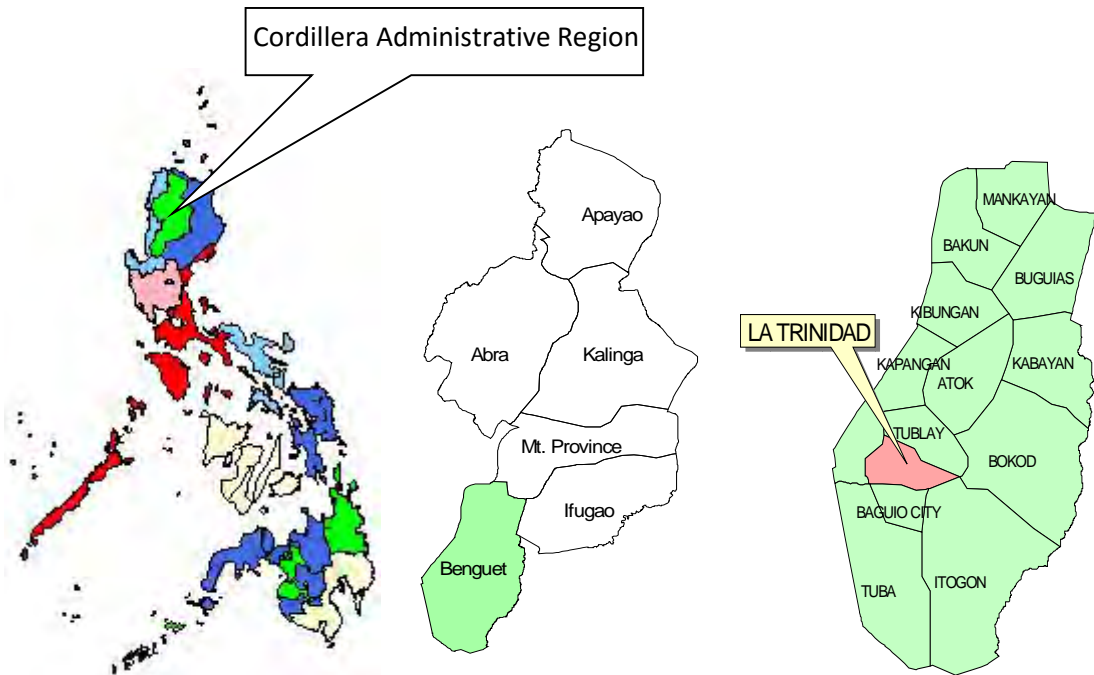

Philippines

Benguet Province



POLITICAL MAP OF BARANGAY BETAG



Not to Scale

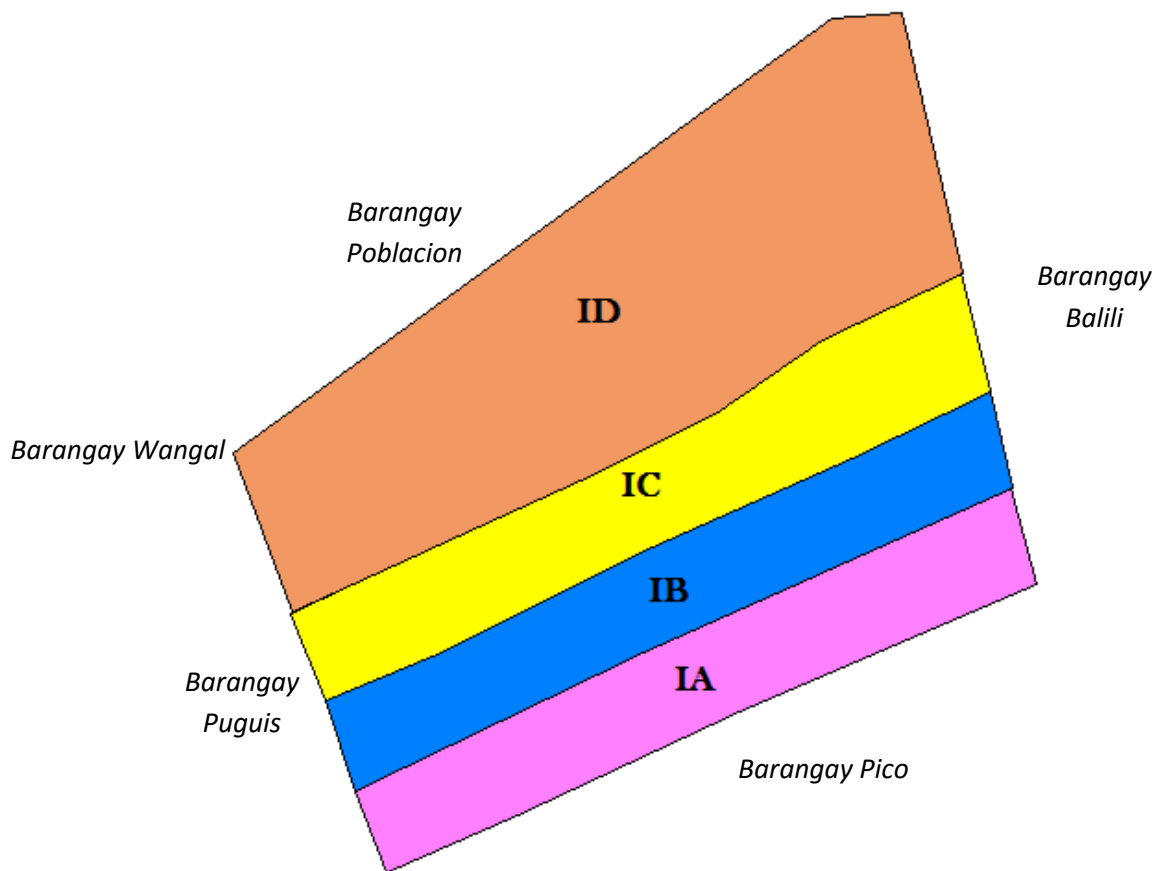

Prepared By: MPDO La Trinidad under the CBMS Project, 2013

Political Subdivisions and Land Area

Barangay Betag occupies a land area of 156.9240 hectares, representing 1.94% of the Municipal land area. It is the fourth from the smallest barangay in the municipality. Betag is subdivided into four zones namely: Zone 1 also known as IA, Zone 2 or IB, Zone 3 or IC and Zone 4 or ID.

III. NATURAL AND PHYSICAL CHARACTERISTICS

Climate and Rainfall







The barangay has an average temperature of 26°C and 16°C at minimum. It is classified under "Type A" climate having two pronounced seasons: dry from November to April and wet during the rest of the year.

Republic of the Philippines
Province of Benguet
Municipality of La Trinidad



BARANGAY BETAG

LEGEND:

- National Road 
- Provincial Road 
- Barangay Road 
- River/Creek 
- Municipal Boundary 
- Barangay Boundary 
- City Boundary 

Not to Scale

Data Source:
BLIST Topographic Map,
Aerial Photograph, 1993

Prepared By:
Municipal Planning &
Development Office
La Trinidad, Benguet

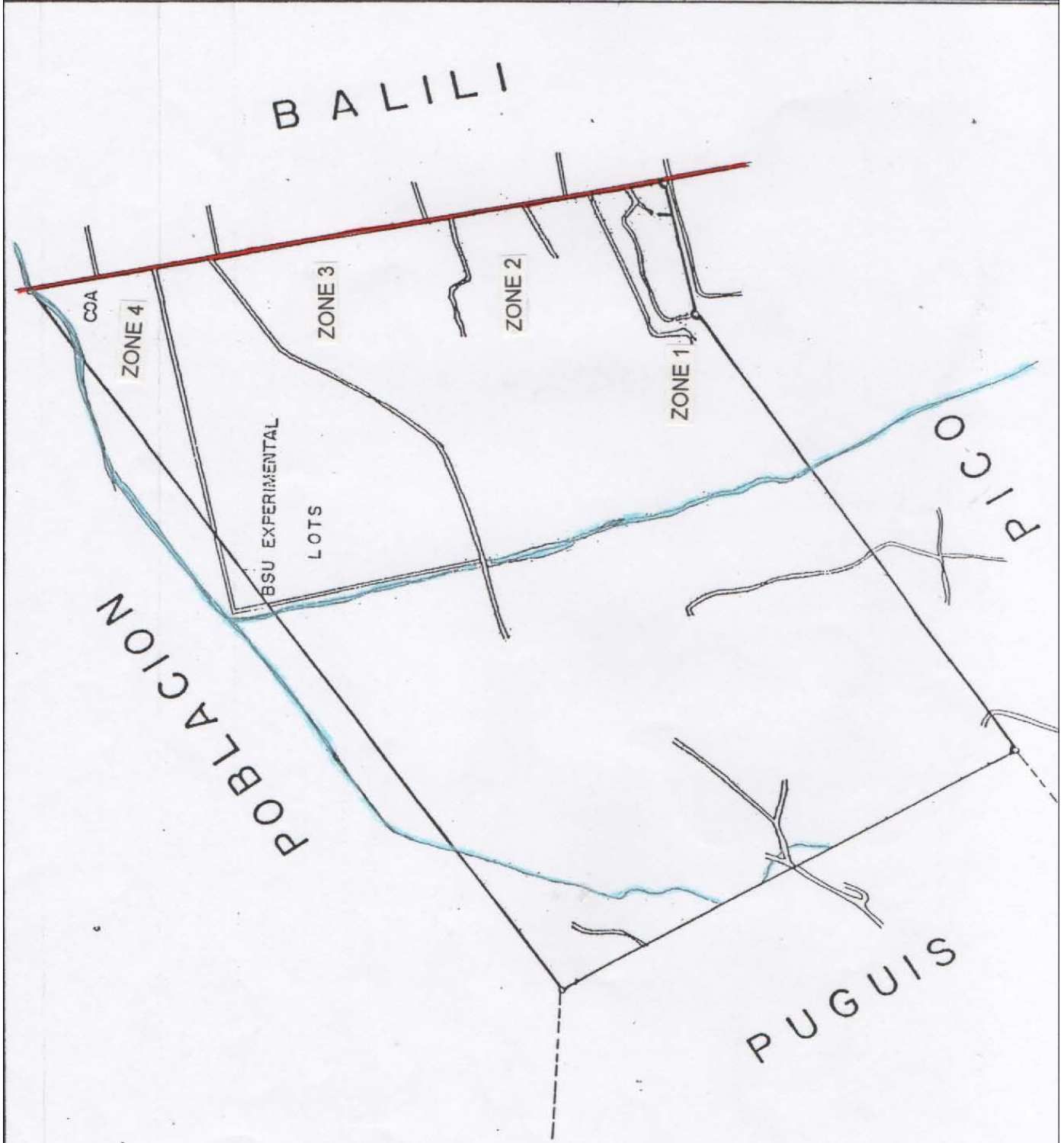

Topography and Slope

The topography of Betag is composed of basically level land with slopes ranging from 0-5% comprising mostly of wet swamp areas. The elevation in the barangay is about 1,400 to 1,500 meters above sea level. This topography makes it suitable for agriculture.

Soil Type

La Trinidad Loam. A major portion of this soil type is found in the barangay. Elevation ranges from 1,400 to 1,500 meters above sea level. It is at level with a depressed area. Drainage is good but during the rainy season, water accumulation in the depressed portion remains stagnant for some time. Organic matter content is 1.17%. This soil type is adapted to many crops. It needs stream bank protection and simple farm management practices to maintain high yield.

Tacdian Loam. Some portions of this soil type are found in the barangay. External drainage is good to excessive. Internal drainage is moderately slow. Elevation ranges from 1,400 to 1,500 meters above sea level. Organic matter content is 4.04%.

When it comes to erosion, this soil type is very critical. The surface soil is very thin and unless it is guarded carefully, the topsoil may be washed off after a few strong rains. All cultivated areas should be terraced properly to minimize erosion.

Buyagan Clay Loam. Some portions of this soil type are found in Betag. It has good to excessive drainage and is prone to soil erosion.

Land Use

Institutional. The dominant land use is institutional. The institutional land covers an area of 51.99 hectares.

Agricultural. The agricultural land covers an area of 44.99 hectares.

Residential. The residential land covers an area of 36.29 hectares.

Road. The road covers an area of 21.75 hectares.

Commercial. The commercial area covers an area of 1.90 hectares.

<i>Land Use</i>	<i>Areas in Hectares</i>	<i>Percentage</i>
Institutional	51.99	33.13%
Agricultural	44.99	28.67%
Residential	36.29	23.13%
Road	21.75	13.86%
Commercial	1.90	1.21%
<i>Total</i>	<i>156.92</i>	<i>100.00%</i>

Source:

MPDO

La

Trinidad,

Benguet

IV. DEMOGRAPHY

Population, Growth, and Population Estimates

According to National Statistics Office records, the population of Betag as of 1975 was 2,026 and has increased to 2,296 in 1980, 4,992 in 1990, and 5,789 in 1995. In year 2000, the population slightly decreased to 5,591, and then increased to 6,235 in 2000 and 6,863 in 2010.

Population: Census years 1975-2010

<i>Census Year</i>	1975	1980	1990	1995	2000	2007	2010
<i>Population</i>	2,026	2,296	4,992	5,789	5,591	6,235	6,863

Source: NSO

The population growth rate between year 1990 and 1995 was 2.8%. This dropped down to -0.74% between years 1995 to 2000 and has increased to 1.57% between 2000 and 2007. Between 2007 and 2010, the population growth rate was 3.25%.

<i>Intercensal Growth Rate</i>				<i>AVERAGE</i>
1990-1995	1995-2000	2000-2007	2007-2010	<i>GROWTH RATE</i>
2.8	-0.74	1.570	3.25	1.72

Source: LT Physical and Socio-economic Profile 2012

Using the obtained average growth rate of 1.72, the projected population for 2013 is 7,223 people with an estimated household of 1,806. For the year 2014, the projected population is 7,348 persons with 1,837 estimated households. For 2015, its projected population is at 7,474 with an estimated household of 1,868.

Estimated Population (2012-2020)

<i>Year</i>	<i>Projected Population</i>	<i>Estimated No. of HHs</i>
2011	6,981	1,745
2012	7,101	1,775
2013	7,223	1,806
2014	7,348	1,837
2015	7,474	1,868
2016	7,602	1,901
2017	7,733	1,933
2018	7,866	1,967
2019	8,002	2,000
2020	8,139	2,035

Source: MPDO Estimates based on NSO Census 1995, 2000, 2007 & 2010

Population Doubling Time: 40.7 years

From the Registry System for Basic Sectors in Agriculture (RSBSA) survey in 2012, the total population of Betag was 8,937. The total number of households was 3,133 with an average household size of 3.

Population by Sitio

Most of the population of Betag is situated in Zone 3 or Sitio IC with 1,608. This is followed by Zone 2 or IB with 1,514 residents. Zone 4 or ID has 411 residents, and Zone 3 or IA has 382 residents.

<i>Sitio/Purok</i>	<i>Households</i>		<i>Population</i>
	<i>#</i>	<i>%</i>	<i>#</i>
IA	127	10.94%	382
IB	469	40.40%	1514
IC	470	40.48%	1608
ID	95	8.18%	411
<i>Total</i>	<i>1,161</i>	<i>100.00%</i>	<i>3,915</i>

Source: CBMS 2010

Density and Classification

The population density in Betag is very high at 31.81 persons per square kilometer in year 1990. This has increased to 36.89 persons per square kilometer in 1995. In year 2000, the population density was 35.63 persons per square kilometer and has increased to 39.73 persons per square kilometer in 2007. This has further increased to 44 persons per square kilometer in 2010. Based on the densities given, Betag is classified as urban barangay.

Population Density (Persons per Square Km)

<i>Census Year</i>	1990	1995	2000	2007	2010
<i>Density</i>	31.81	36.89	35.63	39.73	44

Source: LT Physical & Socio-Economic Profile 2012

Population by Sex and Age Groups

Females in the age groups 20-24 have the highest number which accounted to 8.07% of the total population. Males who belong to age groups 20-24 have the greatest number in the male group, representing 5.95%.

The total sex ratio was 88.04% which means that for every 100 females, there were 88 males. A ratio higher than 100% indicates that male population is predominant to that of the female population. This can be seen in age groups 0-4, 30-34, 35-39, 40-44, 50-54, and 60-64. A ratio lesser than 100% indicates that female population is greater compared to that of the male population. This can be seen in age groups 5-9, 10-14, 15-19, 20-24, 25-29, 45-49, 55-59, 65-69, 70-74, 75-79, and 80 years old and above.

AGE-SEX PYRAMID 2010

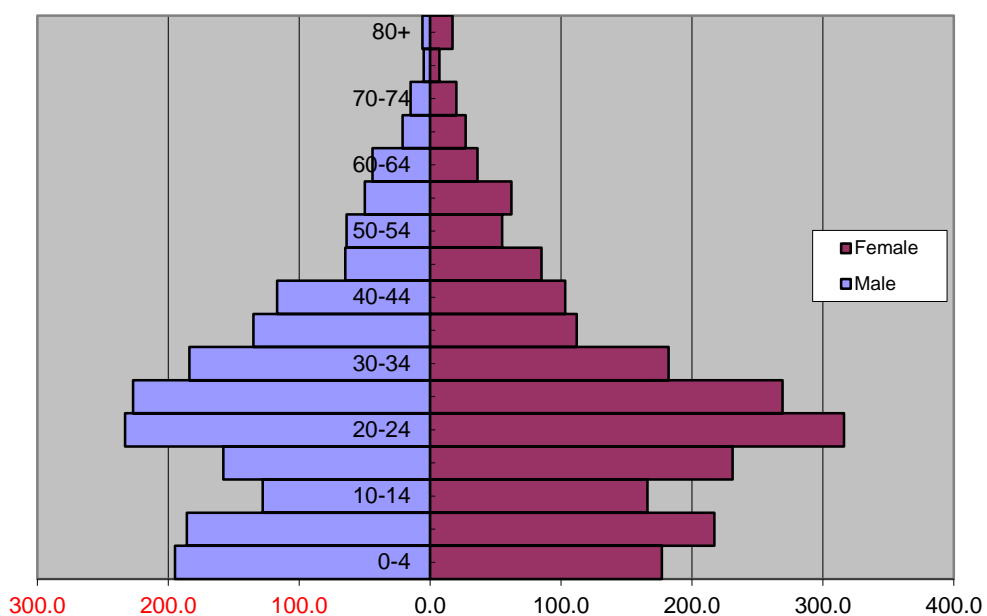

	0-4	5-9	10-14	15-19	20-24	25-29	30-34	35-39	40-44	45-49	50-54	55-59	60-64	65-69	70-74	75-79	80+
Female	177.	217.	166.	231.	316.	269.	182.	112.	103.	85.0	55.0	62.0	36.0	27.0	20.0	7.0	17.0
Male	-195.	-186.	-128.	-158.	-233.	-227.	-184.	-135.	-117.	-65.0	-64.0	-50.0	-44.0	-21.0	-15.0	-5.0	-6.0

Population by Sex and Age Groups

Age	Total	Male	Female	% Male	%Female	Sex Ratio
0-4	372	195	177	4.98%	4.52%	110.17%
5-9	403	186	217	4.75%	5.54%	85.71%
10-14	294	128	166	3.27%	4.24%	77.11%
15-19	389	158	231	4.04%	5.90%	68.40%
20-24	549	233	316	5.95%	8.07%	73.73%
25-29	496	227	269	5.80%	6.87%	84.39%
30-34	366	184	182	4.70%	4.65%	101.10%
35-39	247	135	112	3.45%	2.86%	120.54%
40-44	220	117	103	2.99%	2.63%	113.59%
45-49	150	65	85	1.66%	2.17%	76.47%
50-54	119	64	55	1.63%	1.40%	116.36%
55-59	112	50	62	1.28%	1.58%	80.65%
60-64	80	44	36	1.12%	0.92%	122.22%
65-69	48	21	27	0.54%	0.69%	77.78%
70-74	35	15	20	0.38%	0.51%	75.00%
75-79	12	5	7	0.13%	0.18%	71.43%
80+	23	6	17	0.15%	0.43%	35.29%
Total	3,915	1,833	2,082	46.82%	53.18%	88.04%

Source: CBMS 2010

<i>Age Group</i>	<i>Male</i>	<i>Female</i>	<i>Both Sexes</i>	<i>Proportion</i>
all ages	1833	2082	3,915	100%
0	0	2	2	0.05%
1	44	41	85	2.17%
2	60	50	110	2.81%
3	40	47	87	2.22%
4	51	37	88	2.25%
5	45	56	101	2.58%
6	39	37	76	1.94%
7	29	37	66	1.69%
8	36	46	82	2.09%
9	37	41	78	1.99%
10	38	37	75	1.92%
11	18	35	53	1.35%
12	24	31	55	1.40%
13	22	33	55	1.40%
14	26	30	56	1.43%
15	33	32	65	1.66%
16	29	36	65	1.66%
17	25	45	70	1.79%
18	45	68	113	2.89%
19	26	50	76	1.94%
20	44	56	100	2.55%
21-25	234	322	556	14.20%
26-30	227	251	478	12.21%
31-35	175	168	343	8.76%
36-40	123	100	223	5.70%
41-45	109	97	206	5.26%
46-50	68	85	153	3.91%
51-55	57	54	111	2.84%
56-60	53	61	114	2.91%
61-65	33	34	67	1.71%
66 & over	43	63	106	2.71%

Source: CBMS 2010

Age Dependency

There were 2,728 members of the working age group, representing 69.68% of the total population. The total dependents are 1,187 which comprised of 1,069 young-age dependents and 118 elderly, representing 30.32%.

<i>Dependency Ratios</i>	<i>#</i>	<i>% to Total</i>	<i>Ratios</i>
Young-Age Dependency Ratio (0-14)	1,069	27.39%	39.19
Old-Age Dependency Ratio (65+)	118	3.01%	4.33
Age Dependency Ratio (Total Dependent)	1,187	30.32%	43.51
Working Age Group (15-64)	2,728	69.68%	56.49

Source: CBMS 2010

Median Age

The median age of the total population of Betag is 25 years old, which indicates that the half of the total population belongs to the young population ages 24 years old and below.

Migration

There were 1,329 total migrants in Betag, representing 33.95% of the total population. This comprised of 591 males representing 44.47% and 738 females representing 55.53%. The in-migration rate is very high at 193.65% which indicate that Betag is an in-migration area.

<i>Migration by Sex</i>	<i>#</i>	<i>%</i>
Male	591	44.47%
Female	738	55.53%
<i>Total to Population</i>	<i>1,329</i>	<i>100.00%</i>

Source: CBMS 2010

In-Migration Rate : 193.65%

Length of Residency

In terms of length of residency, there were 1,342 individuals who have stayed in the barangay since birth, representing 34.28% of the total population. Residents who have stayed in the barangay for a period of 0-5 years were at 1,330 which accounted to 33.97%. Four hundred seventy eight (478) persons stayed in the barangay for a period of 6-10 years, representing 12.21% of the total.

<i>Length of Residency</i>	<i>#</i>	<i>%</i>
0 - 5 Years	1,330	33.97%
6 - 10 Years	478	12.21%
11 - 15 Years	228	5.82%
16 - 20 Years	176	4.50%
21 - 25 Years	119	3.04%
26 - 30 Years	89	2.27%
31 - 35 Years	59	1.51%
36 - 40 Years	45	1.15%
41 - 45 Years	16	0.41%
46 - 50 Years	13	0.33%
51 - 55 Years	6	0.15%
56 - 60 Years	9	0.23%
61 - 65 Years	1	0.03%
66 Years and Above	3	0.08%
Since Birth	1,342	34.28%
Not Stated	1	0.03%
<i>Total</i>	<i>3,915</i>	<i>100.00%</i>

Source: CBMS 2010

V. SOCIAL CHARACTERISTICS

A. CULTURAL ATTRIBUTES

Religious Affiliation

Majority of the total population or 2,126 individuals belong to the Catholic sect which accounted to 54.30%. This is followed by Protestants with 667 members, representing 17.04%. There were 207 individuals who are members of Anglican Church, representing 5.29%. Members of Born Again Christians were at 196, representing 5.01% of the total.

<i>Religion</i>	<i>#</i>	<i>%</i>	<i>Religion</i>	<i>#</i>	<i>%</i>
-----------------	----------	----------	-----------------	----------	----------

Aglipay	8	0.20%	Jehovah's Witnesses	22	0.56%
Anglican	207	5.29%	Jesus Miracle	2	0.05%
Assembly of God	52	1.33%	JMPM	4	0.10%
Baligi	1	0.03%	KKLSI	2	0.05%
Baptist	81	2.07%	KKMI	8	0.20%
Born Again Christian	196	5.01%	KKMLFI	4	0.10%
Calvary	6	0.15%	Latter Day Saints	4	0.10%
Catholic	2,126	54.30%	Lutheran	38	0.97%
Christian Science	12	0.31%	Mormon	2	0.05%
Church of Christ	6	0.15%	Nazarene	2	0.05%
Church of God	8	0.20%	Pentecostal	104	2.66%
CTCOPI	1	0.03%	Protestant	667	17.04%
Episcopal Church	10	0.26%	Seventh Day Adventist	22	0.56%
Espiritista	18	0.46%	TCDNC	2	0.05%
Evangelical	12	0.31%	UCCP	42	1.07%
FBCFI	11	0.28%	Vision	2	0.05%
Free Believers	9	0.23%	Wesleyan	8	0.20%
GMPM	8	0.20%	None	17	0.43%
HCEF	3	0.08%	Not Stated	3	0.08%
Iglesia ni Cristo	185	4.73%			
Islam	0	0.00%	<i>Total</i>	<i>3,895</i>	<i>100.00%</i>

Source: CBMS 2010

Membership to a Community Organization (10 years old and above)

In terms of community affairs participation, only 211 individuals were members of a community organization with 90 males and 121 females, representing 6.72%. While majority or 2,929 persons were not members to any community organization, 1,362 of them were males and 1,567 were females, representing 93.28%.

<i>Membership To A Community Organization</i>	<i>Male</i>	<i>Female</i>	<i>Total</i>	<i>%</i>
Member	90	121	211	6.72%
Non-Member	1,362	1,567	2,929	93.28%
<i>Total</i>	<i>1,452</i>	<i>1,688</i>	<i>3,140</i>	<i>100.00%</i>

Source: CBMS 2010

Most of those who are members of a community organization were senior citizens which comprised of 29 males and 52 females, representing 38.39% of the total. Members of civic associations were at 48, of which 28 were males and 20 were females and accounted to 22.75%. The religious group had 17 members, of which 6 males and 11 females, representing 8.06%.

<i>Type of Community Organizations</i>	<i>Male</i>	<i>Female</i>	<i>Total</i>	<i>%</i>
Religious Group	6	11	17	8.06%
Youth Group	2	2	4	1.89%
Cultural Group	5	6	11	5.21%
Political Group	0	0	0	0.00%
Women's Organization	0	9	9	4.27%
Agricultural-based Organization	5	2	7	3.32%
Labor Organization	7	8	15	7.11%
Civic Association	28	20	48	22.75%
Cooperative	3	4	7	3.32%
Senior Citizens Association	29	52	81	38.39%
Others	5	7	12	5.69%
<i>Total</i>	<i>90</i>	<i>121</i>	<i>211</i>	<i>100.00%</i>

Source: CBMS 2010

Ethnicity

More than half of the total population or 2,134 persons belong to the Kankanaey ethnic group, representing 54.51%. There were also 576 individuals who are Ibaloi, representing 14.71%. The Ilocanos were at 476 and the Applais were at 138, representing 12.16% and 3.52% respectively. The rest of the population belong to other various ethnic groups.

<i>Indigenous Group</i>	<i>#</i>	<i>%</i>	<i>Indigenous Group</i>	<i>#</i>	<i>%</i>
Aberling/aborlin	1	0.03%	Itneg	3	0.08%
Adasen	3	0.08%	Itom	1	0.03%
Aeta	4	0.10%	Kalanguya	49	1.25%
Applai	138	3.52%	Kalinga	36	0.92%
Badjao	1	0.03%	Kankanaey	2,134	54.51%
Bago	25	0.64%	Kapampangan	9	0.23%
Balangao	1	0.03%	Mangyan	2	0.05%
Batangeño	4	0.10%	Pangasinense	65	1.66%
Bicolano	10	0.26%	Tagalog	5	0.13%
Bisaya	3	0.08%	Tingguian	1	0.03%
B'laan	3	0.08%	Tuwali	20	0.51%
Bontoc	21	0.54%	Waray	4	0.10%
Dumagat	1	0.03%	Yaloka	2	0.05%
Ibaloi	576	14.71%	Zambal	1	0.03%
Ibanag	8	0.20%	No Indigenous Tribe	239	6.10%
Ifugao	24	0.61%	Not Stated	32	0.82%
Ilocano	476	12.16%			
Ilongo	13	0.33%	<i>Total</i>	<i>3,915</i>	<i>100.00%</i>

Source: CBMS 2010

B. EDUCATION

Literacy (10 years old and above)

The literacy rate of Betag is high at 98.66% with 3,098 individuals who are 10 years old and above. This comprised of 1,432 males and 1,666 females. There were 41 persons who are illiterate where 20 of them were males and 21 were females, representing 1.31%.

<i>Literacy (10 years old and above)</i>	<i>Male</i>	<i>Female</i>	<i>Total</i>	<i>%</i>
Literate	1,432	1,666	3,098	98.66%
Illiterate	20	21	41	1.31%
Not Stated	0	1	1	0.03%
<i>Total</i>	<i>1,452</i>	<i>1,688</i>	<i>3,140</i>	<i>100.00%</i>

Source: CBMS 2010

There were 1,210 individuals who are still going to school, representing 30.91%. This consists of 518 males and 692 females. A total of 2,705 persons were no longer attending school with 1,315 males and 1,390 females, representing 69.09% of the total population.

<i>Attending School By Sex</i>	<i>Male</i>	<i>Female</i>	<i>Total</i>	<i>%</i>
Attending School	518	692	1,210	30.91%
Not attending School	1,315	1,390	2,705	69.09%
<i>Total</i>	<i>1,833</i>	<i>2,082</i>	<i>3,915</i>	<i>100.00%</i>

Source: CBMS 2010

Educational Attainment of Population Aged 3 years old and above

As to educational attainment, there were 305 who were not in school with 152 males and 153 females, representing 8.20%. Persons who were able to go to day care accounted to 78.

There were 37 males and 41 females, representing 2.10%. Sixty one (61) persons were able to enter nursery, kindergarten, or preparatory, of which 29 were males and 32 were females, representing 1.64%.

A total of 438 persons were in elementary. There were 192 persons who were able to graduate elementary with 91 males and 101 females, representing 5.16%. Three hundred twenty one (321) persons were able to enter high school. Six hundred eighty five (685) graduated from high school, 353 males and 331 females, representing 18.40% of the total.

There were 633 individuals who were able to reach college, representing 17.02%. A number of 783 were able to graduate from college with 308 males and 475 females, representing 21.06%. Seven (7) individuals were able to obtain units in masters and/or doctorates, 4 of them were males and 3 were females, representing 0.19%. Sixteen (16) persons were able to finish their doctors and/or master's degree with 6 males and 10 females, representing 0.43%.

<i>Educational Attainment By Age</i>	<i>Male</i>	<i>Female</i>	<i>Total</i>	<i>%</i>
No Grade	152	153	305	8.20%
Day Care	37	41	78	2.10%
Nursery/Kindergarten/Preparatory	29	32	61	1.64%
Grade 1	35	48	83	2.23%
Grade 2	38	42	80	2.15%
Grade 3	50	50	100	2.69%
Grade 4	36	51	87	2.34%
Grade 5	40	32	72	1.94%
Grade 6/7	7	9	16	0.43%
Elementary Graduate	91	101	192	5.16%
1st Year High School	41	43	84	2.26%
2nd Year High School	67	51	118	3.17%
3rd Year High School	51	55	106	2.85%
4th/5th Year High School	7	6	13	0.35%
High School graduate	353	331	684	18.40%
1st year Post Secondary	17	9	26	0.70%
2nd year Post Secondary	27	17	44	1.18%
3rd year Post Secondary	2	0	2	0.05%
Post Secondary graduate	74	52	126	3.39%
1st year College	55	87	142	3.82%
2nd year College	96	151	247	6.64%
3rd year College	88	109	197	5.30%
4th year College or higher	17	30	47	1.26%
College graduate	308	475	783	21.06%
With units Masters/Doctors	4	3	7	0.19%
Doctors/Master's degree	6	10	16	0.43%
Not Stated	1	1	2	0.05%
<i>Total</i>	<i>1,729</i>	<i>1,989</i>	<i>3,718</i>	<i>100.00%</i>

Source: CBMS 2010

Educational Attainment of those in School

For those who are still attending school, there were 58 who are enrolled in day care, where 27 were males and 31 were females, representing 4.79%. Nursery, kindergarten, or preparatory had 74 enrollees with 33 males and 41 females, representing 6.12%. Among the

grade levels, grade 2 had the highest number of enrollees of 78. Thirty two (32) were males and 46 were females, representing 6.45%. Another 78 pupils were enrolled in grade 4 with 39 males and 39 females, representing 6.45%.

There were 53 students enrolled in first year high school, of which 16 were males and 37 were females, representing 4.38% of the total population. Second year high school had 57 enrollees, 27 males and 30 females which accounted to 4.71%. Fifty nine (59) were enrolled in third year high school with 30 males and 29 females, representing 4.88%. Fourth year high school level had 56 enrollees, comprised of 26 males and 30 females, representing 4.63%.

First year college had 97 enrollees with 42 males and 55 females, representing 8.02%. There were 98 students enrolled in second year college, where 36 were males and 62 were females, representing 8.10%. Students enrolled in third year college were at 96 with 36 males and 60 females and is accounted to 7.93%. Fourth year college had 98 enrollees of which 36 were males and 62 were females, representing 8.10%. Eleven (11) persons were enrolled with some units for master or doctors with 4 males and 7 females which accounted to 0.91%.

<i>Grade/Year Level</i>	<i>Male</i>	<i>Female</i>	<i>Total</i>	<i>%</i>
Day Care	27	31	58	4.79%
Nursery/Kindergarten/Preparatory	33	41	74	6.12%
Grade 1	34	35	69	5.70%
Grade 2	32	46	78	6.45%
Grade 3	33	38	71	5.87%
Grade 4	39	39	78	6.45%
Grade 5	30	42	72	5.95%
Grade 6/7	29	35	64	5.29%
1st Year High School	16	37	53	4.38%
2nd Year High School	27	30	57	4.71%
3rd Year High School	30	29	59	4.88%
4th/5th Year High School	26	30	56	4.63%
1st year Post Secondary	3	5	8	0.66%
2nd year Post Secondary	2	5	7	0.58%
3rd year Post Secondary	3	3	6	0.50%
1st year College	42	55	97	8.02%
2nd year College	36	62	98	8.10%
3rd year College	36	60	96	7.93%
4th year College or Higher	36	62	98	8.10%
Post Graduate with Units	4	7	11	0.91%
<i>Total</i>	<i>518</i>	<i>692</i>	<i>1,210</i>	<i>100.00%</i>

Source: CBMS 2010

Attending School by Age Group (3 to 21 year old)

From the school going age of 3 to 21, there were a total of 1,478 members of the community comprising of 657 males and 821 females. This represents 37.75% of the total population. Out of the school going age, 1,073 persons were in school, representing 72.60%. Four hundred five (405) persons were not in school, representing 27.40%.

For the pre-school age, most of them were not in school. For those 6 to 12 years old suitable for elementary, at least more than 92% were in school except for those in age group of 6 where 80% were in school. For the ages appropriate for high school, at least 95% were in

school except for age groups 15 and 16 where 87.69% and 84.62% were in school. For ages suitable for college, there were less compared to those in the lower school levels.

Age Group	Sex			In School		Out of School	
	Male	Female	Total	#	% to Age Group	#	% to Age Group
3	40	47	87	2	2.30%	85	97.70%
4	51	37	88	15	17.05%	73	82.95%
5	45	56	101	61	60.40%	40	39.60%
6	39	37	76	61	80.26%	15	19.74%
7	29	37	66	61	92.42%	5	7.58%
8	36	46	82	78	95.12%	4	4.88%
9	37	41	78	78	100.00%	0	0.00%
10	38	37	75	74	98.67%	1	1.33%
11	18	35	53	52	98.11%	1	1.89%
12	24	31	55	55	100.00%	0	0.00%
13	22	33	55	54	98.18%	1	1.82%
14	26	30	56	53	94.64%	3	5.36%
15	33	32	65	57	87.69%	8	12.31%
16	29	36	65	55	84.62%	10	15.38%
17	25	45	70	59	84.29%	11	15.71%
18	45	68	113	87	76.99%	26	23.01%
19	26	50	76	59	77.63%	17	22.37%
20	44	56	100	58	58.00%	42	42.00%
21	50	67	117	54	46.15%	63	53.85%
3-21	657	821	1,478	1,073	72.60%	405	27.40%
22-25	184	255	439	97	22.10%	342	77.90%
26-30	227	251	478	30	6.28%	448	93.72%
31-35	175	168	343	2	0.58%	341	99.42%
36 & over	485	494	979	8	0.82%	971	99.18%
<i>Total</i>	<i>1,728</i>	<i>1,989</i>	<i>3,717</i>	<i>1,210</i>		<i>2,507</i>	

Source: CBMS 2010

Educational Facilities and Enrollment

School Level	Name of School	Enrollment (2011-12)	Category
Pre-school &	Brilliant Child Christian Academy	67	Private
Elementary	Full Bright Preparatory School, Inc.	84	Private
	Keys of the Kingdom Ministries Learning Center	101	Private
	Epiphany Learning Center Inc.	418	Private
Technical Vocational	Cordillera Quest		Private
	Jekkara Overseas Training Center, Inc.		Private
	Montañosa College		Private
	La Trinidad Valley Institute of Technology		Private

Source: DepEd-LT, TESDA, 2012

Type of School Enrolled In

As to type of school enrolled in, 716 were enrolled in public schools, representing 59.17% of the total of those in school. Students enrolled in private schools were at 494 which accounted to 40.83% of the total.

Enrollment by School Type	Total	%
---------------------------	-------	---

Public School	716	59.17%
Private School	494	40.83%
<i>Total</i>	<i>1,210</i>	<i>100.00%</i>

Source: CBMS 2010

Sports and Recreation Facilities : Physical Fitness Gym
: Open Basketball Court
: Closed Gym

C. HEALTH

Health Facilities

Barangay Betag's health station is situated at the second floor of Barangay Multi-Purpose Hall. The midwife holds clinic on Mondays, Wednesdays and morning of Fridays and conducts home visits during Tuesdays. Private clinics and the Benguet General Hospital are just few meters away from the Barangay Health Station.

Treatment for Sickness

As of 2010, there were a total of 1,146 household members who got sick. Only 157 of them were able to avail of medical treatment, representing 13.52%. A number of 989 were not able to avail medical treatment, representing 85.19%. There were 14 household members who did not get sick, representing 1.21% of the total households.

<i>Received Treatment/Cure For Sickness</i>	<i>HHs</i>	<i>%</i>
Yes	157	13.52%
No	989	85.19%
Did Not Get Sick	14	1.21%
Not Stated	1	0.09%
<i>Total</i>	<i>1,161</i>	<i>100.00%</i>

Source: CBMS 2010

Access to Health Facilities

Most of the patients or 58 of them availed of treatment in a private clinic or hospital, representing 36.94%. There were 56 patients who availed treatment in provincial public hospitals, representing 35.67%. Patients who availed of medical treatment in municipal public hospital accounted to 32, representing 20.38%.

<i>Place Where Received Treatment</i>	<i>#</i>	<i>%</i>
Public hospital (provincial)	56	35.67%
Public hospital (municipal)	32	20.38%
Public hospital (district)	1	0.64%
Public hospital (national)	2	1.27%
Private hospital/clinic	58	36.94%
Rural health units	5	3.18%
Barangay health station/center	3	1.91%
Non-medical/Non-trained Hilot/Personnel	0	0.00%
Others	0	0.00%
<i>Total</i>	<i>157</i>	<i>100.00%</i>

Source: CBMS 2010

Mortality

Sixteen (16) deaths were recorded in 2010 for barangay Betag. It consists of 12 males and 4 females, representing 0.41% of the total population. There were 5 casualties due to disease of the heart with 4 males and 1 female, representing 31.25%. Two males died due to disease of the vascular system, representing 12.50%. Another 2 individuals died due to cancer, a

male and a female, representing 12.50%. Seven (7) other deaths were recorded due to other causes, representing 43.75%.

<i>Cause of Death</i>	<i>Male</i>	<i>Female</i>	<i>Total</i>	<i>#</i>
Diseases of the heart	4	1	5	31.25%
Diseases of the vascular system	2	0	2	12.50%
Cancer	1	1	2	12.50%
Others	5	2	7	43.75%
<i>Total</i>	<i>12</i>	<i>4</i>	<i>16</i>	<i>100.00%</i>

Source: CBMS 2010

Nutritional Status of Children (0-5 years old)

There were 881 children ages 0 to 5 years old with 422 males and 459 females. Most children or 867 are of normal weight with 415 males and 452 females, representing 98.41% of the total number of children. Eleven (11) children were underweight. Five (5) of them were males and 6 were females, representing 1.25%. Two (2) male children were severely underweight, representing 0.23%. One (1) female was overweight, representing 0.11% of the total.

<i>Nutritional Status of Children 0-5 Years Old</i>	<i>Male</i>	<i>Female</i>	<i>Total</i>	<i>%</i>
Overweight	0	1	1	0.11%
Normal	415	452	867	98.41%
Underweight	5	6	11	1.25%
Severely Underweight	2	0	2	0.23%
<i>Total</i>	<i>422</i>	<i>459</i>	<i>881</i>	<i>100.00%</i>

Source: MHO 2012

Family Planning Methods Usage

There were 682 couples in the community. The number of women at child-bearing age was at 623, but only 237 couples were practicing family planning method.

<i>Number of Couples</i>	:	<i>682</i>
<i>Number of Married Women of Child-bearing Age</i>	:	<i>623</i>
<i>Couples Practicing Family Planning</i>	:	<i>237</i>

Most of the couples who are practicing family planning used pills as contraceptive, representing 47.68%. Couples who used injectable were at 36 which accounted to 15.19%. Twenty eight (28) couples adapted tubal ligation, representing 11.81%. Nineteen (19) couples adapted barrier method, representing 8.02% of the couples practicing family planning.

<i>Couples by Family Planning Method</i>	<i>#</i>	<i>%</i>
Barrier Method	19	8.02%
Basal Body Temperature	4	1.69%
Billings Ovulation Method	1	0.42%
Injectible	36	15.19%
IUD	7	2.95%
Lactational Amenorrhea Method	0	0.00%
Pills	113	47.68%
Standard Days Method	16	6.75%
Symtothermal Method	5	2.11%
Tubal Ligation	28	11.81%
Vasectomy	1	0.42%
Don't Know	3	1.27%
Others	4	1.69%
<i>Total</i>	<i>237</i>	<i>100.00%</i>

Source: CBMS 2010

Contraceptive Prevalence Rate : 38.04 of Currently Married Women (CWM)
15-49 Years Old Use Contraceptive Methods

: 36.92% of CWM 15-49 Years Old Use
Modern Contraceptive Method

: 1.12% of CWM 15-49 Years Old Use
Traditional Contraceptive Method

Environmental Sanitation

Solid Waste Management

Waste Generation. The total waste generated daily in Betag was 5 metric tons. This comprised of 3.73 metric tons in residential area, 0.54 metric ton from institutions (schools and offices), 1 metric ton from market (stalls from Swamp), 0.10 metric ton from business establishments and 0.04 from the farms.

<i>Estimated Total Waste Generated</i> : <i>5 metric tons(mt) daily</i>			
Residential	: 3.73 mt	Commercial	: 0.10 mt
Institutional	: 0.54 mt	Agriculture	: 0.04 mt
Markets	: 1.00 mt		

Source: MPDO Estimate based on 0.534 kg/person/day

System of Garbage Disposal. As to system of garbage disposal, garbage collection was adapted by 1,158 households, representing 99.74% of the total households. There were 1,029 households who segregate their garbage, representing 88.63%. Households who do recycling were at 851 households which accounted to 73.30%. A total of 364 households do composting, representing 31.35% of the total.

<i>System of Garbage Disposal</i>	<i>#</i>	<i>% to total HHs</i>
Garbage Collection	1,158	99.74%
Burning	48	4.13%
Composting	364	31.35%
Recycling	851	73.30%
Waste Segregation	1,029	88.63%
Compost Pit with Cover	75	6.46%
Compost Pit without Cover	88	7.58%
Others	2	0.17%

Source: CBMS 2010

Garbage Collection. Most of the garbage in the barangay was collected by the municipal garbage collector. There were 1,147 households was served by the municipal garbage collector, representing 98.79%. Garbage of 11 households was collected by the barangay garbage collector which accounted to 0.95%. Three (3) households were not serviced by any garbage collector at all.

<i>Who Collects the Garbage</i>	<i>#</i>	<i>%</i>
Municipal garbage collector	1,147	98.79%
Barangay garbage collector	11	0.95%
Private garbage collector	0	0.00%
None	3	0.26%
<i>Total</i>	<i>1,161</i>	<i>100.00%</i>

Source: CBMS 2010

Collection Frequency. Most of the households brought out their garbage at the collection point twice a week, representing 38.85% of the total households. There were 344 households whose garbage were brought out and collected daily which accounted to 29.63%. Garbage of 341 households was collected thrice a week and which accounted to 29.37%.

<i>Frequency of Garbage Collection</i>	<i>#</i>	<i>%</i>
Daily	344	29.63%
Thrice a Week	341	29.37%
Twice a Week	451	38.85%
Once a Week	22	1.89%
None	3	0.26%
<i>Total</i>	<i>1,161</i>	<i>100.00%</i>

Source: CBMS 2010

Sanitation Facilities

There were 606 households who have their own flush toilets with septic tanks, representing 52.20% of the total households. Five hundred forty eight (548) households shared with other households' septic tanks representing 47.20%. Only 7 households used closed pit, representing 0.60% of the total.

<i>Kind of Toilet Facility</i>	<i>#</i>	<i>%</i>
Water-sealed Flush to Sewerage/Septic Tank- own	606	52.20%
Water-sealed Flush to Sewerage/Septic Tank- shared	548	47.20%
Close Pit	7	0.60%
Open Pit	0	0.00%
No Toilet	0	0.00%
<i>Total</i>	<i>1,161</i>	<i>100.00%</i>

Source: CBMS 2010

D. HOUSING

Residential Construction

In 2012, a total of 23 new buildings were constructed in barangay Betag. This accounted for 6.08% of the total number of new buildings constructed in the municipality of La Trinidad.

House Ownership

Majority of the households or 634 households were renting house or room including lot, representing 54.61% of the total households. There were 403 households who are owners of house and lot which accounted to 34.71%. Households living in a rent-free house and lot with consent of the owner accounted to 109, representing 9.39%.

<i>Households by Tenure Status</i>	<i>#</i>	<i>%</i>
Owner, owner-like possession of house and lot	403	34.71%
Rent house/room including lot	634	54.61%
Own house/rent lot	1	0.09%
Own house, rent-free lot with consent of owner	11	0.95%
Own house, rent-free lot without consent of owner	2	0.17%
Rent-free house and lot with consent of owner	109	9.39%
Rent-free house and lot without consent of owner	0	0.00%
Other tenure status	1	0.09%
<i>Total</i>	<i>1,161</i>	<i>100.00%</i>

Source: CBMS 2010

Average Imputed Rent per Month for the House and Lot: ₱6,342

Minimum Imputed Rent : ₱100

Maximum Imputed Rent : ₱36,000

Construction Materials of Housing Units

According to construction materials used for walls, 1,098 household dwellings have walls made of strong materials, representing 94.57% of the total households. There were 20 household dwellings whose walls were made up of mixed materials but predominantly strong, accounted to 1.72%. Another 18 household dwelling have walls made of salvaged or makeshift materials, representing 1.55% of the total.

<i>Households by Type of Materials Used for Walls</i>	<i>#</i>	<i>%</i>
Strong Materials	1098	94.57%
Light Materials	10	0.86%
Salvaged/Makeshift Materials	18	1.55%
Mixed but Predominantly Strong	20	1.72%
Mixed but Predominantly Light	14	1.21%
Mixed but Predominantly Salvage	0	0.00%
Not Stated	1	0.09%
<i>Total</i>	<i>1,161</i>	<i>100.00%</i>

Source: CBMS 2010

For roofing materials, there were 1,098 households whose roofs were made up of strong materials representing 94.57% of the total households. Roofs of 32 household dwellings were made out of mixed materials but predominantly strong, representing 2.76%. Roofs of 18 household dwellings were made of mixed materials but predominantly light and accounted to 1.55% of the total.

Imputed Rent: If those house and lot is owned or being used for free, the imputed rent refers to the amount the owner would charge to rent the housing unit.

<i>Households by Type of Materials Used for Roof</i>	<i>#</i>	<i>%</i>
--	----------	----------

Strong Materials	1098	94.57%
Light Materials	8	0.69%
Salvaged/Makeshift Materials	4	0.34%
Mixed but Predominantly Strong	32	2.76%
Mixed but Predominantly Light	18	1.55%
Mixed but Predominantly Salvage	0	0.00%
Not Stated	1	0.09%
<i>Total</i>	<i>1161</i>	<i>100.00%</i>

Source: CBMS 2010

Household Conveniences

The LPG Gas Stove/Range was the most commonly owned home appliance by 1,115 households, representing 96.04% of the total number of households. This is followed by mobile/cellular phones owned by 1,070 households and which accounted to 92.16%. There were 932 households who owned a television, representing 80.28%.

The radio/radio cassette was owned by 832 households, representing 71.66%. There were 712 households who owned a CD/VCD/DVD player which accounted to 61.33%. Five hundred seventy (570) households owned an electric iron, representing 49.10%. A total of 466 households owned a refrigerator or freezer, representing 40.14% of the total households.

<i>Households With Appliances/Durables</i>	<i>#</i>	<i>%</i>
Radio/Radio Cassette	832	71.66%
Television	932	80.28%
CD/VCD/DVD	712	61.33%
Stereo/Component	106	9.13%
Karaoke	50	4.31%
Refrigerator/Freezer	466	40.14%
Electric Fan	198	17.05%
Electric Iron	570	49.10%
LPG Gas Stove/Range	1,115	96.04%
Washing Machine	418	36.00%
Microwave Oven	173	14.90%
Personal Computer	362	31.18%
Mobile Phone/Cellular Phone	1,070	92.16%
Landline Telephone	98	8.44%
Air-conditioner	16	1.38%
Sewing Machine	68	5.86%
Car, Jeep, Motorcycle and Other Motorized Vehicles	195	16.80%

Source: CBMS 2010

E. SOCIAL WELFARE

Daycare Center Facilities

Betag Day Care Center
Betag Day Care Center Extension

Clientele Groups

Solo Parents

There were 74 solo parents in the community comprised of 19 males and 55 females, representing 6.37% of the total population. The top reason for being a solo parent was due to death of spouse. This accounted to 31 individuals with 5 males and 26 females representing 41.89% of the total number of solo parents. This is followed by abandonment of spouse with 25 individuals which comprised of 8 males and 17 females, representing 33.78%. There were 13 solo parents due to non-marriage, where 6 were males and 7 were females, representing 17.57% of the total.

<i>Reasons For Being A Solo Parent</i>	<i>Male</i>	<i>Female</i>	<i>Total</i>	<i>%</i>
Death of Spouse	5	26	31	41.89%
Imprisonment of Spouse	0	1	1	1.35%
Legal Separation from Spouse for At least One Year	0	1	1	1.35%
Annulment of Marriage	0	1	1	1.35%
Abandonment of Spouse for At least One Year	8	17	25	33.78%
Unmarried Mother/Father Who Preferred to Keep the Child Instead of Others Caring for Her/him	6	7	13	17.57%
Assumes the Responsibility of the Head of the Family	0	1	1	1.35%
Other Reason	0	1	1	1.35%
<i>Total</i>	<i>19</i>	<i>55</i>	<i>74</i>	<i>100.00%</i>

Source: CBMS 2010

Persons with Disability

A total of 35 persons with disability were recorded in Betag, which composed of 24 males and 11 females, representing 0.89% of the total population. There were 5 persons who were severely intellectually impaired consisting of 4 males and a female, representing 14.29% of the total persons with disabilities. Four (4) individuals were partially blind, of whom 2 were males and 2 were females, representing 11.43%. Another 4 persons, all males, have severe cerebral palsy, representing 11.43% of the total.

<i>Persons With Disability By Type</i>	<i>Male</i>	<i>Female</i>	<i>Total</i>	<i>%</i>
Total Blindness	1	1	2	5.71%
Partial Blindness	2	2	4	11.43%
Partially Deaf	0	1	1	2.86%
Hard of Hearing	0	1	1	2.86%
Oral Defect	0	2	2	5.71%
One Hand	1	0	1	2.86%
One Leg	1	0	1	2.86%
Mild Cerebral Palsy	2	0	2	5.71%
Severe Cerebral Palsy	4	0	4	11.43%
Severely Intellectually Impaired	4	1	5	14.29%
Regularly Impaired by Mental Illness	1	0	1	2.86%
Severely Impaired by Mental Illness	2	1	3	8.57%
Others	6	2	8	22.86%
<i>Total</i>	<i>24</i>	<i>11</i>	<i>35</i>	<i>100.00%</i>

Source: CBMS 2010

As to cause of disability, there were 16 individuals, 9 males and 7 females, whose disability was in-born with, representing 45.71% of the total. Disabilities of 11 persons were due to illness, where 8 were males and 3 were females, representing 31.43%. Five (5) disabled persons acquired disability (4 males and a female) were due to accident with, representing 14.29%. Another 3 disabled persons acquired disability were due to other causes, representing 8.57%.

<i>Cause Of Disability</i>	<i>Male</i>	<i>Female</i>	<i>Total</i>	<i>%</i>
In-born	9	7	16	45.71%
Illness	8	3	11	31.43%
Accident	4	1	5	14.29%
Others	3	0	3	8.57%
<i>Total</i>	<i>24</i>	<i>11</i>	<i>35</i>	<i>100.00%</i>

Source: CBMS 2010

One (1) disabled person availed of medical assistance, representing 2.86% of the total. Another 2 disabled person availed of other kinds of assistance other than medical and financial assistance, representing 5.71%. The sources of assistance availed of were from Government with 2 recipients and from other source with 1 recipient.

<i>Assistance Received</i>	<i>Total</i>	<i>%</i>
Medical Assistance	1	2.86%
Others	2	5.71%
<i>Total</i>	<i>3</i>	<i>8.57%</i>

<i>Source of Assistance Received</i>	<i>#</i>	<i>%</i>
Government	2	5.71%
NGO	0	0.00%
Others	1	2.86%
<i>Total</i>	<i>3</i>	<i>8.57%</i>

Source: CBMS 2010

Senior Citizens

There were 143 senior citizens in the community with 90 males and 53 females which accounted to 6.21% of the total population. Of the total, 101 senior citizens (62 males and 39 females) have their identification cards, representing 70.63%. There were 42 senior citizens, 28 males and 14 females, do not have identification cards, representing 29.37%. Only 19 seniors were able to use their identification cards. Eleven (11) were males and 8 were females which accounted to 18.81% of the total number of senior citizens.

<i>Senior Citizen ID Usage</i>	<i>Male</i>	<i>Female</i>	<i>Total</i>	<i>%</i>
Members Who was Able to Use ID	11	8	19	18.81%
With Identification Card	62	39	101	70.63%
Without Identification Card	28	14	42	29.37%
<i>Total</i>	<i>90</i>	<i>53</i>	<i>143</i>	<i>6.21%</i>

Source: CBMS 2010

Access to Government Programs

Of the total households, 256 of them were able to benefit from all various types of the Government programs. Most of the households or 154 in number were beneficiaries of Health Assistance program, representing 60.16%. There were 75 households who were recipients of Philhealth for Indigents, representing 29.30%. Recipients of education or scholarship program were 21 households which accounted to 8.20% of the total. Majority of the recipients of the various programs said that the effects of the programs were good.

<i>Types of Programs Received/Availed by the HHs</i>	<i>#</i>	<i>%</i>
Philhealth for Indigents	75	29.30%
Supplemental Feeding Program	2	0.78%
Health assistance program	154	60.16%
Education / scholarship program	21	8.20%
Skills or livelihood training program	1	0.39%
Housing program	1	0.39%
Credit program	1	0.39%
Other types of program, specify	1	0.39%
<i>Total</i>	<i>256</i>	<i>100.00%</i>

Source: CBMS 2010

<i>Program Effect Rating</i>	<i>#</i>	<i>%</i>
Positive	247	96.48%
No Effect	9	3.52%
Negative Effect	0	0.00%
<i>Total</i>	<i>256</i>	<i>100.00%</i>

Source: CBMS 2010

F. PUBLIC SAFETY

Peace and Order

There were 121 incidents of crime in the community in 2012. Vehicular accident has the most in number with 61, representing 50.41%. This is followed by theft with 14 incidents and physical injuries with 12, representing 11.57% and 9.92% respectively. Other non-index crimes had 10 incidents which accounted to 8.26%.

<i>Victims of Crime</i>	<i>#</i>	<i>%</i>
Car napping	2	1.65%
Child Abuse	4	3.31%
Homicide	1	0.83%
Other Non-index	10	8.26%
Physical Injuries	12	9.92%
Rape	2	1.65%
Robbery	7	5.79%
Theft	14	11.57%
VAWC	8	6.61%
Vehicular Accidents	61	50.41%
<i>Total</i>	<i>121</i>	<i>100.00%</i>

Source: PNP-La Trinidad, 2012 data

Calamity

A total of 234 households said that they were affected by natural and/or man-made calamities, representing 20.16% of the total households. Most of the affected households were victims of flood with 139 in number, representing 59.40%. There were 95 households who were affected by typhoons, representing 40.60% of the total victims of calamities.

<i>Types of Calamities</i>	<i>#</i>	<i>%</i>
Typhoon	95	40.60%
Flood	139	59.40%
Drought	0	0.00%
Earthquake	0	0.00%
Volcanic Eruption	0	0.00%
Armed Conflict	0	0.00%
Fire	0	0.00%
Others	0	0.00%
<i>Total</i>	<i>234</i>	<i>100.00%</i>

Source: CBMS 2010

VI. ECONOMY

A. SOURCE OF INCOME

Entrepreneurial Activities

A total of 437 households were engaged in entrepreneurial activities, representing 37.64% of the total households. There were 215 households engaged in wholesale and retail trade activities with an average annual income of P100,771.00. Households engaged in crop farming and gardening were at 71 having an average income of P102,500.00 annually.

Transportation, storage, and communication services have 34 households with an average annual income of P257,591.00. Another 32 households were engaged in construction sector having an average income of P129,422.00 annually. There were 15 households engaged in community, social and personal services with an average annual income of P119,800.00.

<i>Entrepreneurial Activities by Income</i>	<i>Households</i>		<i>Income (P)</i>		
	<i>#</i>	<i>%</i>	<i>Minimum</i>	<i>Average</i>	<i>Maximum</i>
Crop Farming and Gardening	71	6.12%	₱7,000.00	₱102,500.00	₱768,000.00
Livestock and Poultry Raising	7	0.60%	20,000.00	56,000.00	122,000.00
Fishing Activities	0	0.00%	0	0	0
Forestry and Hunting Activities	0	0.00%	0	0	0
Wholesale & Retail Trade Activities	215	18.52%	6,000.00	100,771.00	960,000.00
Manufacturing Activities	6	0.52%	36,000.00	174,683.00	480,000.00
Community, Social & Personal	15	1.29%	24,000.00	119,800.00	240,000.00
Transportation, Storage, and Communication Services	34	2.93%	11,200.00	257,591.00	3,120,000.00
Mining and Quarrying Activities	9	0.78%	60,000.00	99,628.00	192,000.00
Construction	32	2.76%	20,000.00	129,422.00	600,000.00
Other Activities	48	4.13%	5,000.00	77,856.00	540,000.00
<i>Total</i>	<i>437</i>	<i>37.64%</i>			

Source: CBMS 2010

Salaries and Wages

Households who were wage earners accounted for 64% of the total households. This comprised of 743 households with an average income of P160,963.00 annually.

<i>Salaries and Wages by Income</i>	<i>Households</i>		<i>Income (P)</i>		
	<i>#</i>	<i>%</i>	<i>Minimum</i>	<i>Average</i>	<i>Maximum</i>
Salaries and Wages	743	64.00%	₱6,000.00	₱160,963.00	₱3,240,000.00

Source: CBMS 2010

Additional Source of Income

Aside from the main source of income, 591 households have other source of additional income. There were 163 households who receive remittances from Overseas Filipino Workers with an average annual income of P107,781.00. One hundred forty five (145) households had additional income from cash receipts, support, assistance and relief from domestic sources with an average income of P65,885.00 annually. Another 139 households received additional income from rentals of agricultural lands, spaces, buildings and other properties having an average income of P158,701.00 annually.

<i>Additional Sources of Income</i>	<i>Number of HHs</i>	<i>Minimum Income</i>	<i>Average Income</i>	<i>Maximum Income</i>
Net Share of Crops, Livestock, and Poultry Raised by Other Households	22	₱10,000.00	₱49,396.00	₱123,000.00
Remittances from Overseas Filipino Workers	163	3,000.00	107,781.00	625,000.00
Receipts from Abroad	21	2,000.00	51,376.00	228,000.00
Receipts from Domestic Sources	145	3,000.00	65,885.00	350,000.00
Rentals Received	139	5,400.00	158,701.00	3,000,000.00
Interest Earned	26	100.00	63,973.00	600,000.00
Pension and Retirement Received	40	5,000.00	85,352.00	1,118,688.00
Dividends from Investment	4	5,000.00	33,250.00	60,000.00
Other Sources	31	6,000.00	67,455.00	620,000.00
<i>Total</i>	<i>591</i>			

Source: CBMS 2010

Annual Per Capita Poverty Threshold

There were 54 households whose annual per capita income less than the poverty threshold which is ₱15,820. This represents 4.65% of the total household in the barangay. The annual per capita poverty threshold is the minimum annual income required to be spent by each member of a family to satisfy their nutritional requirements and other basic needs. Two (2) households said that they experienced food shortage for three months probably during typhoons.

Agriculture

A total of 71 households were engaged in agriculture (excludes farm laborers), representing 6.12% of the total households.

Tenure Status. Most of the households or 52 households were renting the agricultural land they were working on, representing 73.24% of the total households who were engaged in agriculture. There were 15 households who owned the land they were tilling, representing 19.72%. Five (5) households do not own the land they were cultivating but with the consent of the owner, accounted for 7.04% of the total.

<i>Tenure Status (Agricultural Land)</i>	<i>#</i>	<i>%</i>
Owned or owner-like possession	14	19.72%
Rent	52	73.24%
Not owned but with consent of owner	5	7.04%
Not owned and without consent of owner	0	0.00%
Other	0	0.00%
<i>Total</i>	<i>71</i>	<i>100.00%</i>

Source: CBMS 2010

Agricultural Land Area. There were 64 households who worked on agricultural land which is less than one hectare, representing 91.55%. Four (4) households were cultivating 1 to 3 hectares of agricultural land, representing 5.63%. There were 2 households who worked on 3 to 5 hectares of agricultural land which accounted to 2.82% of the total farmers.

<i>Area of Agricultural Land</i>	<i>#</i>	<i>%</i>
Less Than 1 Hectare	65	91.55%
1 - 3 Hectares	4	5.63%
3.1 - 5 Hectares	2	2.82%
More Than 5 Hectares	0	0.00%
Not Specified	0	0.00%
<i>Total</i>	<i>71</i>	<i>100.00%</i>

Source: CBMS 2010

Agricultural Implements. There were 264 farmers who owned the equipment or facilities they used in the farm, representing 92.31% of the total farmers. Twenty two (22) farmers do not own the equipment or facilities they used, representing 7.69%. Sixty five (65) farmers used insecticide or pesticide sprayer, representing 22.73%. The irrigation pump was used by 42 farmers, accounted for 14.69%. Nine (9) farmers owned a plow, representing 3.15%.

<i>Ownership of Equipment/Facilities</i>	<i>#</i>	<i>%</i>
Yes	264	92.31%
No	22	7.69%
<i>Total</i>	<i>286</i>	<i>100.00%</i>
<i>Type of Agricultural Equipment/Facilities Used</i>	<i>#</i>	<i>%</i>
Beast of Burden	2	0.70%
Plow	9	3.15%
Harrow	2	0.70%
Thresher or Corn Sheller	2	0.70%
Insecticide or Pesticide Sprayer	65	22.73%
Farm Tractor	4	1.40%
Hand Tractor	6	2.10%
Multipurpose Drying Pavement	2	0.70%
Harvester, Any Crop	2	0.70%
Warehouse Granary	2	0.70%
Farm Shed	6	2.10%
Irrigation Pump	42	14.69%
Other Equipments/Facilities	142	49.65%

Source: CBMS 2010

Livestock Raising

Only 9 households were engaged in livestock raising. Six (6) households raised hog for fattening, representing 66.67%. Sow was raised by one household and chicken was raised by another household. A household raised chicken for egg laying.

<i>Livestock Being Raised by Households</i>	<i>#</i>	<i>%</i>
Hog for Fattening	6	66.67%
Sow	1	11.11%
Goat	0	0.00%
Carabao	0	0.00%
Cow	0	0.00%
Chicken	1	11.11%
Chicken for Egg Laying	1	11.11%
Duck	0	0.00%
Other Livestock/Poultry	0	0.00%
<i>Total</i>	<i>9</i>	<i>100.00%</i>

Source: CBMS 2010

There were 436 live animals, 4,230 kilograms of meat and 4,000 pieces of eggs which were produced annually by those households engaged in livestock and poultry raising.

<i>Volume of Production of Livestock/Poultry</i>	<i>Volume of Production</i>
Live animals	436 heads

Meat	4,230 kgs.
Milk	0 liters
Eggs	4,000 pcs.

Source: CBMS 2010

B. EMPLOYMENT

Labor Force

There were 2,727 members of the potential labor force comprised of 1,276 males and 1,451 females, representing 69.66% of the total population. The actual labor force is 1,664 persons with 961 males and 703 females, which excludes those who are unable, not available and not looking for work (e.g. students, disabled, housewives, retired persons and seasonal workers). There were 1,577 employed members of the potential labor force which composed of 1,548 persons who are 15-64 years old, 1 person who is 14 years old and below, and 28 persons who are 65 years old and above. This garnered a high employment rate of 94.77%. Eighty seven (87) individuals were not employed, representing 5.23% of the total actual labor force.

<i>Labor Force</i>	<i>Male</i>	<i>Female</i>	<i>Total</i>	<i>%</i>
Potential Labor Force (15-64 years old)	1,276	1,451	2,727	
<i>Actual Labor Force</i>				
Employed	921	656	1,577	94.77%
<i>Employed Members (15-64 Years Old)</i>	905	643	1,548	93.03%
<i>Employed Members (14 Years Old & Below)</i>	1	0	1	0.06%
<i>Employed Members (65 Years Old & Above)</i>	15	13	28	1.68%
<i>Unemployed Members Who are Looking for Work</i>	40	47	87	5.23%
Actual Labor Force	961	703	1,664	100.00%

Source: CBMS 2010

Nature of Employment

Out of 1,577 persons employed, 1,216 individuals were permanently employed with 708 males and 508 females, representing 77.11%. Individuals employed in short-term, seasonal or casual basis accounted for 321 with 185 males and 136 females, representing 20.36%. There were also 40 individuals who worked on different jobs on day to day or week to week basis. There were 28 males and 12 females, representing 2.54% of the total number of employed individuals.

<i>Nature of Employment</i>	<i>Male</i>	<i>Female</i>	<i>Total</i>	<i>%</i>
Permanent	708	508	1,216	77.11%
Short-term, seasonal, casual	185	136	321	20.36%
Worked on different jobs on day to day/week to week	28	12	40	2.54%
<i>Total</i>	<i>921</i>	<i>656</i>	<i>1,577</i>	<i>100.00%</i>

Source: CBMS 2010

Employment by Sector

Most of the employed members were in wholesale and retail trade sector. It has an aggregate of 479 persons, 231 males and 248 females, representing 30.37% of the total number of employed. Transportation, storage and communication sector hired 150 persons with 138 males and 12 females, representing 9.51%. The agriculture, mining and forestry sector employed 149 persons, 102 males and 47 females, representing 9.45%.

There were 147 individuals employed in education sector with 46 males and 101 females, representing 9.32%. Construction sector hired 109 persons composed of 98 males and 11 females, representing 6.91%. Some 95 individuals (66 males and 29 females) were employed in public administration and defense which accounted to 6.02% of the total.

<i>Employment By Sector/Industry</i>	<i>Male</i>	<i>Female</i>	<i>Total</i>	<i>%</i>
Agriculture, Mining, and Forestry	102	47	149	9.45%
Fishing	0	2	2	0.13%
Mining and Quarrying	25	6	31	1.97%
Manufacturing	12	20	32	2.03%
Electricity, Gas, and Water Supply	28	5	33	2.09%
Construction	98	11	109	6.91%
Wholesale & Retail Trade, Vehicle Repair	231	248	479	30.37%
Hotel and Restaurants	34	42	76	4.82%
Transportation, Storage, and Communication	138	12	150	9.51%
Financial Intermediation	13	17	30	1.90%
Real Estate, Renting, and Business Activities	31	11	42	2.66%
Public Administration and Defense	66	29	95	6.02%
Education	46	101	147	9.32%
Health and Social Work	11	29	40	2.54%
Other Community, Social/Personal Activities	48	32	80	5.07%
Private HHs with Employed Persons	37	43	80	5.07%
Extra- territorial Organization	1	1	2	0.13%
<i>Total</i>	<i>921</i>	<i>656</i>	<i>1,577</i>	<i>100.00%</i>

Source: CBMS 2010

Primary Occupation or Business

There were 329 persons who are service workers and shop and market sales workers, where 155 were males and 174 were females, representing 20.86%. Laborers and unskilled workers were at 306 with 224 males and 82 females, representing 19.40%. Some 203 individuals were physical, mathematical and engineering science professionals, of whom 72 were males and 131 were females, representing 12.87%.

Trades and related workers were at 182 with 80 males and 102 females, representing 11.54%. There were 138 persons who are plant and machine operators and assemblers with 133 males and 5 females which accounted to 8.75%. Farmers, forestry workers, and fishermen accounted to 89 males and 33 females, representing 7.74% of the total.

<i>Type Of Primary Occupation Or Business</i>	<i>Male</i>	<i>Female</i>	<i>Total</i>	<i>%</i>
Officials of Gov't & Special-Interest Organizations, Corporate Executives, Managers, Managing Proprietors & Supervisors	59	42	101	6.40%
Physical, Mathematical & Engineering Science Professionals	72	131	203	12.87%
Technician and Associate Professionals	47	25	72	4.57%
Clerks	20	52	72	4.57%
Service Workers and Shop and Market Sales Workers	155	174	329	20.86%
Farmers, Forestry Workers and Fishermen	89	33	122	7.74%
Trades and Related Workers	80	102	182	11.54%
Plant and Machine Operators and Assemblers	133	5	138	8.75%
Laborers and Unskilled Workers	224	82	306	19.40%
Special Occupations	42	10	52	3.30%
<i>Total</i>	<i>921</i>	<i>656</i>	<i>1,577</i>	<i>100.00%</i>

Source: CBMS 2010

Class of Worker

Most of the employed or 612 individuals, 366 males and 246 females, were workers for a private establishment, representing 38.81%. This is followed by 410 persons who were self-employed without employees, where 223 were males and 187 were females which accounted to

26%. Two hundred seventy two (272) were workers for a household with 172 males and 100 females, representing 17.25% of the total.

<i>Class Of Worker</i>	<i>Male</i>	<i>Female</i>	<i>Total</i>	<i>%</i>
Worked for a household	172	100	272	17.25%
Worked for a private establishment	366	246	612	38.81%
Worked for government/ government corporation	95	90	185	11.73%
Self-employed without employees	223	187	410	26.00%
Employer in own family-operated farm or business	49	26	75	4.76%
Worked with pay on own family operated farm/business	13	5	18	1.14%
Work without pay on own family operated farm/business	3	2	5	0.32%
<i>Total</i>	<i>921</i>	<i>656</i>	<i>1,577</i>	<i>100.00%</i>

Source: CBMS 2010

Professionals

There were 199 professionals in Betag with 133 males and 66 females, representing 5.08% of the total population. Most of the professionals or 75 persons were professional teachers with 47 males and 28 females, representing 37.69%. Nurses were at 42 comprised of 28 males and 14 females, and accounted to 21.11%. Some 17 individuals were criminologists with 16 males and 1 female, representing 8.54% of the total number of professionals.

There were 10 certified public accountants 10 (6 males and 4 females), representing 5.03%. There were 5 individuals who are agriculturists, of which all are males, representing 2.51%. Other 5 persons were midwives comprising 3 males and 2 females which accounted to 2.51% of the total.

<i>Type of Professionals</i>	<i>Male</i>	<i>Female</i>	<i>Total</i>	<i>#</i>
Aeronautical Engineer	0	1	1	0.50%
Agriculturist	5	0	5	2.51%
Attorney-at-Law	3	0	3	1.51%
Certified Plant Mechanic	2	0	2	1.01%
Certified Public Accountant	6	4	10	5.03%
Civil Engineer	7	2	9	4.52%
Criminologist	16	1	17	8.54%
Custom Broker	1	0	1	0.50%
Dentist	0	1	1	0.50%
Elect. and Comm. Engineer	0	3	3	1.51%
Forester	2	0	2	1.01%
Geodetic Engineer	0	1	1	0.50%
Librarian	0	1	1	0.50%
Medical Technologist	1	1	2	1.01%
Midwife	3	2	5	2.51%
Mining Engineer	2	0	2	1.01%
Nurse	28	14	42	21.11%
Pharmacist	2	2	4	2.01%
Professional Agricultural Engineer	2	0	2	1.01%
Professional Teacher	47	28	75	37.69%
Radiologic Technologist	0	1	1	0.50%
Second Engineer Officer	1	0	1	0.50%
Social Worker	2	0	2	1.01%
Others	3	4	7	3.52%
<i>Total</i>	<i>133</i>	<i>66</i>	<i>199</i>	<i>100.00%</i>

Source: CBMS 2010

Unemployment and Job Search Method

A total of 87 individuals were unemployed who were searching for work, which composed of 40 males and 47 females. As a method of searching job, 30 individuals approached their relatives and friends to inquire for work comprising of 14 males and 16 females, representing 34.48%. There were 29 persons who placed or answered a private advertisement, where 14 were males and 15 were females and is accounted to 33.33%. Eleven (11) individuals, 5 males and 6 females, approached the employer directly, representing 12.64%

<i>Job Search Method</i>	<i>Male</i>	<i>Female</i>	<i>Total</i>	<i>%</i>
Registered in public employment agency	2	4	6	6.90%
Registered in private employment agency	5	5	10	11.49%
Approached employer directly	5	6	11	12.64%
Approached relatives/friends	14	16	30	34.48%
Placed or answered private advertisements	14	15	29	33.33%
Others	0	1	1	1.15%
<i>Total</i>	<i>40</i>	<i>47</i>	<i>87</i>	<i>100.00%</i>

Source: CBMS 2010

There were 1,092 members of the potential labor force who are not searching job composing of 332 males and 760 females, representing 40.04% of the total potential labor force. Majority of them were students with 569, where 238 were males and 331 were females, representing 52.11%. A number of 379 persons were not applying for work due to housekeeping duties, of which 16 were males and 363 were females, representing 34.71%. Fifty three (53) persons, 28 males and 25 females were either too young or too old, retired and/or permanently disabled, representing 4.85%.

<i>Reasons For Not Looking For Work</i>	<i>Male</i>	<i>Female</i>	<i>Total</i>	<i>%</i>
Believes no work is available	9	5	14	1.28%
Awaiting results of previous job application	9	13	22	2.01%
Temporary illness/disability	12	6	18	1.65%
Bad Weather	0	0	0	0.00%
Waiting for rehire/job recall	9	3	12	1.10%
Too young/old, retired, permanently disabled	28	25	53	4.85%
Housekeeping	16	363	379	34.71%
Schooling	238	331	569	52.11%
Other reasons	11	14	25	2.29%
<i>Total</i>	<i>332</i>	<i>760</i>	<i>1,092</i>	<i>100.00%</i>

Source: CBMS 2010

Overseas Employment

A total of 140 persons who are former members of the households were Overseas Filipino Workers, of which 85 were males and 55 were females. There were 22 workers in Saudi Arabia, representing 15.71% of the total number of OFWs. Canada hired 16 OFWs, representing 11.43%. Another 16 OFWs were workers in Hong Kong, representing 11.43%. Twelve (12) individuals were workers in United Kingdom, and is accounted to 8.57% of the total.

<i>Country of Work</i>	<i>#</i>	<i>%</i>	<i>Country of Work</i>	<i>#</i>	<i>%</i>
Angola	1	0.71%	Libyan Arab Jamahiriya	1	0.71%
Australia	3	2.14%	Malaysia	4	2.86%
Belgium	1	0.71%	New Zealand	5	3.57%
Brunei Darussalam	1	0.71%	Qatar	3	2.14%
Canada	16	11.43%	Russian Federation	1	0.71%

China	6	4.29%	Saudi Arabia	22	15.71%
Cyprus	2	1.43%	Singapore	5	3.57%
Guam	1	0.71%	Spain	1	0.71%
Greece	3	2.14%	Vietnam	1	0.71%
Hong Kong	16	11.43%	Taiwan	7	5.00%
Ireland	1	0.71%	United Arab Emirates	2	1.43%
Israel	5	3.57%	United Kingdom	12	8.57%
Italy	1	0.71%	United States of America	8	5.71%
Japan	6	4.29%	Others	2	1.43%
Jordan	1	0.71%			
Korea	2	1.43%	<i>Total</i>	<i>140</i>	<i>100.00%</i>

Source: CBMS 2010

Kind of Work Abroad

There were 41 OFWs (26 males and 15 females) who are service workers and shop and market sales workers, representing 29.29% of the total number of OFWs. Overseas Filipino workers who are laborers and unskilled workers accounted to 36 with 25 males and 11 females, representing 25.71%. Twenty four (24) OFWs were physical, mathematical and engineering science professionals, wherein 16 were males and 8 were females, representing 17.14%. There were 17 OFWs who are technician and associate professionals, representing 12.14%.

<i>Kind Of Work Abroad</i>	<i>Male</i>	<i>Female</i>	<i>Total</i>	<i>%</i>
Officials of Gov't & Special-Interest Organizations, Corporate Executives, Managers, Managing Proprietors & Supervisors	3	0	3	2.14%
Physical, Mathematical & Engineering Science Professionals	16	8	24	17.14%
Technician and Associate Professionals	9	8	17	12.14%
Clerks	2	1	3	2.14%
Service Workers and Shop and Market Sales Workers	26	15	41	29.29%
Farmers, Forestry Workers and Fishermen	1	2	3	2.14%
Trades and Related Workers	0	0	0	0.00%
Plant and Machine Operators and Assemblers	2	9	11	7.86%
Laborers and Unskilled Workers	25	11	36	25.71%
Special Occupations	1	1	2	1.43%
<i>Total</i>	<i>85</i>	<i>55</i>	<i>140</i>	<i>100.00%</i>

Source: CBMS 2010

C. INFRASTRUCTURE AND UTILITIES

Electricity

Almost all or 1,157 households had electrical connection with BENEKO, representing 99.66% of the total households. There were 4 households who had no electrical connection, accounted for 0.34%. The average monthly electrical bill was at ₱607.00.

Number of Households with Electricity Connections: 1,157 (99.66% of the total households)

Number of Households w/o Electricity Connections: 4 (0.34% of the total households)

Average Monthly Electrical Bill : ₱ 607.00

<i>Source of Electricity</i>	<i>#</i>	<i>%</i>
Electric Company	1,157	99.66%
Generator	0	0.00%
Solar	0	0.00%
Battery	2	0.17%
Others	1	0.09%

None	1	0.09%
<i>Total</i>	<i>1,161</i>	<i>100.00%</i>

Source: CBMS 2010

Access to Safe Drinking Water

Out of the total households, there were 1,090 households who have access to safe drinking water (bottled water), representing 93.88%. Forty seven (47) households have connection to community water system, representing 4.05%. There were 15 households who shared with other households' water connection, representing 1.29%.

<i>Source of Drinking Water</i>	<i>#</i>	<i>%</i>
Community Water System-own	47	4.05%
Community Water System-shared	15	1.29%
Deep Well-own	3	0.26%
Deep Well-shared	2	0.17%
Artesian Well-own	0	0.00%
Artesian Well-shared	0	0.00%
Dug/Shallow Well-own	0	0.00%
Dug/Shallow Well-shared	0	0.00%
River, Stream, Lake, Spring	1	0.09%
Bottled Water	1,090	93.88%
Tanker Truck/Peddler	2	0.17%
Others	1	0.09%
<i>Total</i>	<i>1,161</i>	<i>100.00%</i>

Source: CBMS 2010

Most or 1,093 households did not specify the distance of the source of their drinking water, representing 94.14% of the total households. There were only 64 households, whose source of drinking water is within their premises, representing 5.51%. Two households' source of drinking water is outside their premises within 250 meters or less, representing 0.17% of the total.

<i>Distance of Source of Drinking Water</i>	<i>#</i>	<i>%</i>
Within Premises	64	5.51%
Outside Premises But 250 Meters/Less	2	0.17%
251 Meters or More	1	0.09%
Don't Know	1	0.09%
Not Stated	1,093	94.14%
<i>Total</i>	<i>1,161</i>	<i>100.00%</i>

Source: CBMS 2010

Domestic Water System

As per record of the La Trinidad Water District for 2013, there were 1,226 households had connection to their domestic water system.

Roads

<i>Name of Road</i>	<i>Length (km)</i>	<i>Road ROW (m)</i>	<i>Area of Jurisdiction</i>	<i>Remarks</i>
Betag Interior Road 1	0.288	4.000	Municipal	Concrete/Gravel
Betag Interior Road 2	0.205	4.000	Municipal	Concrete
Baguio-Bontoc-Swamp-Betag Road	0.523	3.100	Barangay	Concrete/Gravel

Source: CLUP 2000-10 & 2013-2023

CBMS Indicators of Poverty

Unemployment is the most felt problem in barangay Betag of whom 87 individuals were not employed. This comprised 31 unemployed in Sitio IB, another 31 individuals in Sitio IC, 15 unemployed in Sitio ID, and 10 in Sitio IA.

Another most felt problem among the residents is low income wherein 54 households are affected, of whom 26 were in Sitio IB, 23 in Sitio IC, 3 in Sitio IA, and 2 in Sitio ID.

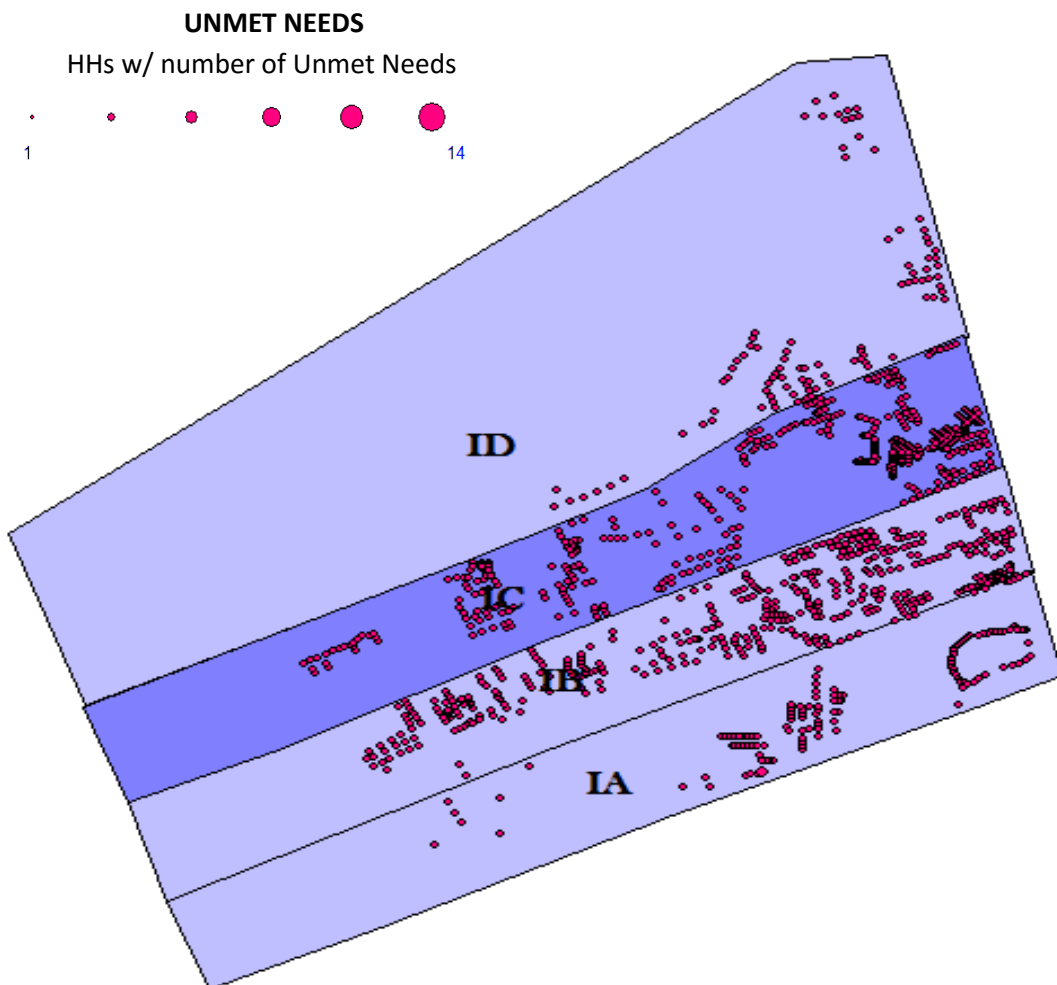

<i>Poverty Indicators/Sitio</i>	<i>IA</i>	<i>IB</i>	<i>IC</i>	<i>ID</i>	<i>Total</i>
A. EDUCATION					
Children Not Attending E/S	0	12	14	0	26
Children Not Attending H/S	0	7	13	2	22
B. HEALTH & NUTRITION					
Children (0-5 years old) who died	0	0	0	0	0
Women who Died	0	0	0	0	0
Malnourished Children	1	1	0	0	2
C. HOUSING					
HH Who are Squatters	1	0	0	0	1
HH in Makeshift Housing	0	0	0	0	0
D. INCOME & LIVELIHOOD					
HH w/ incomes Below Poverty Threshold	3	26	23	2	54
HH w/ incomes Below Food Threshold	2	12	8	0	22
HH who Experienced Hunger	2	0	0	0	2
Unemployed	10	31	31	15	87
E. WATER & SANITATION					
HH without Access to Safe Water	0	0	0	0	0
HH with No Sanitary Toilet	0	0	0	0	0

Source: CBMS 2010, as verified by Barangay Officials in 2012